

SMART BELT

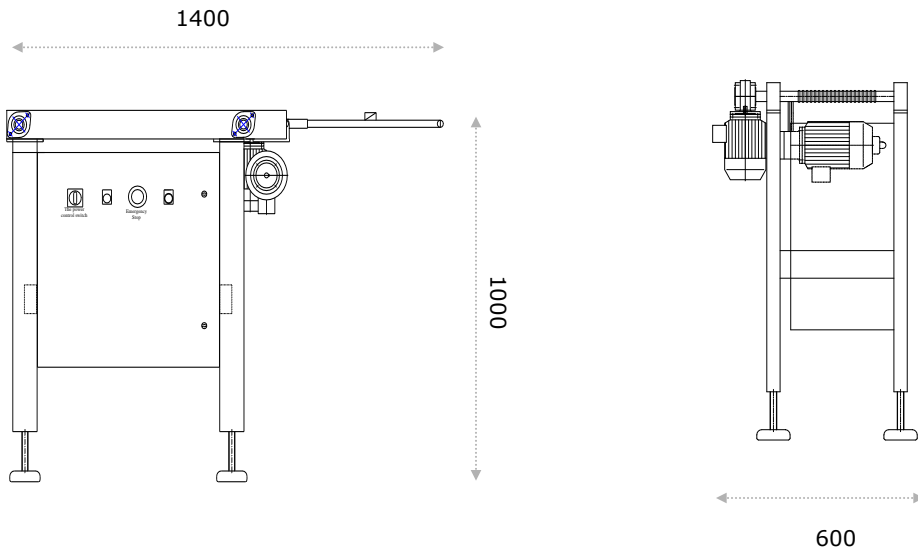

SMART-BELT



The smart-belt is a servo-controlled unit which by means of encoder signals from a carton machine or similar machines is used for conveying products into cartons or in the cassette belt of the carton machine. The products may come at random intervals e.g. from freezer, flow-packer etc.

Product size and speeds are adjusted to our cartoning and closing machines.

Smart-belt

Constructed in stainless steel

Electricity supply: 3 x 380 VAC-N-PE, 1.5 kW

(We reserve the right to alter specifications without prior notice)

Aug. 2015